

Gloucester Walk,
W8

Approx Gross Internal Area
655 sq ft / 61 sq m

**RUSSELL
SIMPSON**

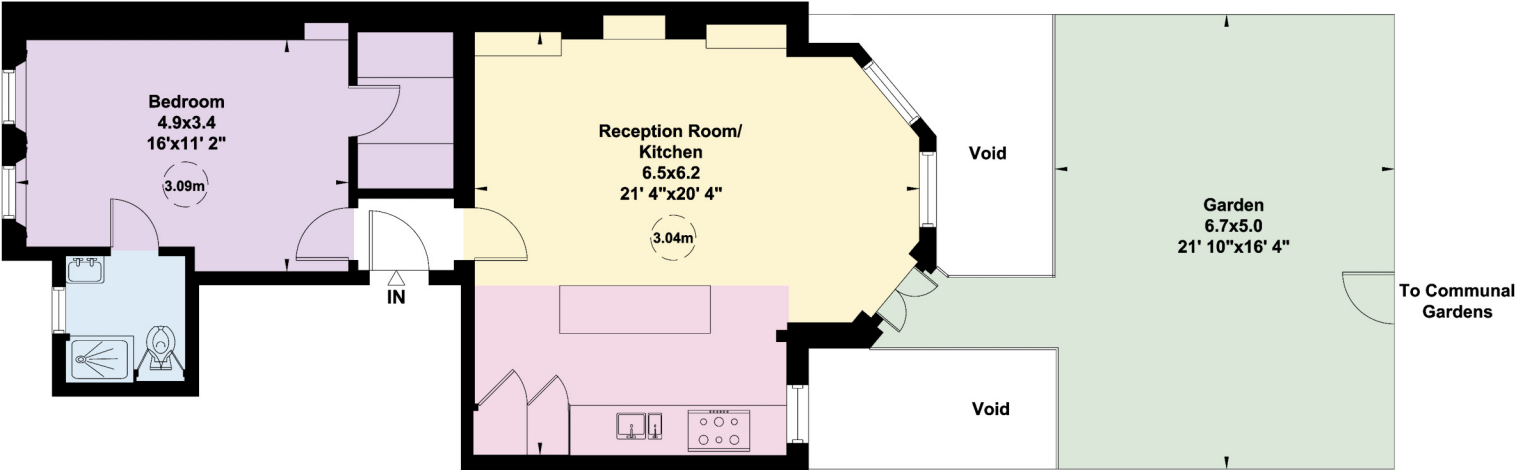
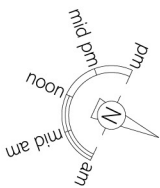

RAISED GROUND FLOOR

This plan is for layout guidance only. Not drawn to scale unless stated. Windows and door openings are approximate. Whilst every care is taken in the preparation of this plan. Please check all dimensions, shapes, and compass bearings before making any decisions reliant upon them.