

# Queen Street, W1

**RUSSELL  
SIMPSON**

**Approximate Internal Area**

1,920 sq ft/ 178 sq m

**Including limited use area**

13 sq ft/ 1 sq m

**Outside Area**

506 sq ft/ 47 sq m

This plan is for layout guidance only. Not drawn to scale unless stated. Windows and door openings are approximate. Whilst every care is taken in the preparation of this plan, please check all dimensions, shapes, and compass bearings before making any decisions reliant upon them.



Fourth Floor

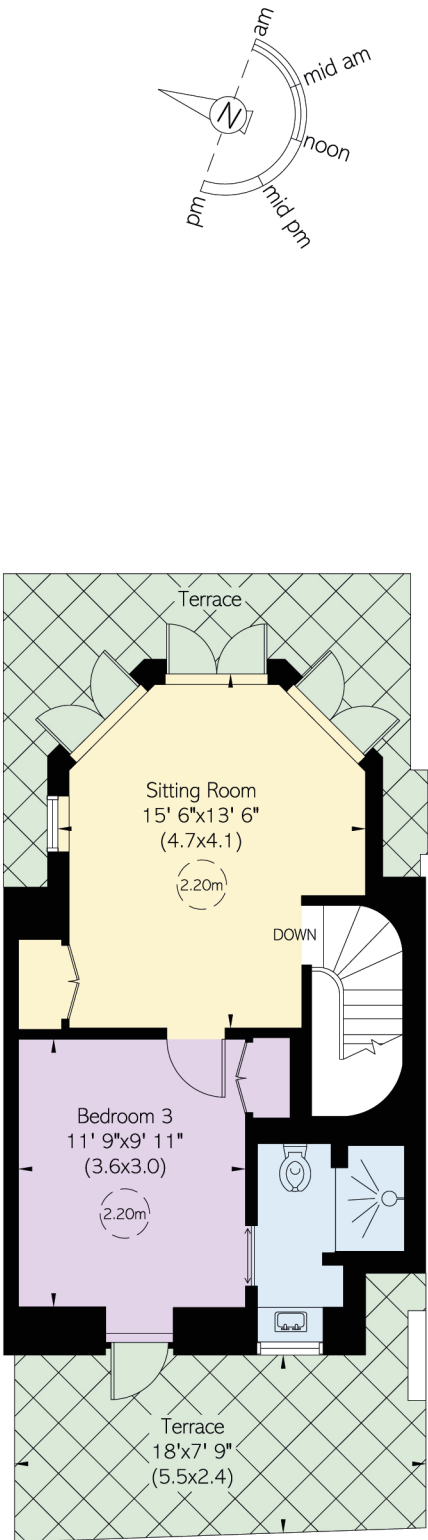

Fifth Floor