

Stratton Street, W1

Approximate Internal Area
1,584 sq ft/ 147 sq m

RUSSELL
SIMPSON

This plan is for layout guidance only.
Not drawn to scale unless stated. Windows
and door openings are approximate. Whilst
every care is taken in the preparation of this
plan, please check all dimensions, shapes,
and compass bearings before making any
decisions reliant upon them.

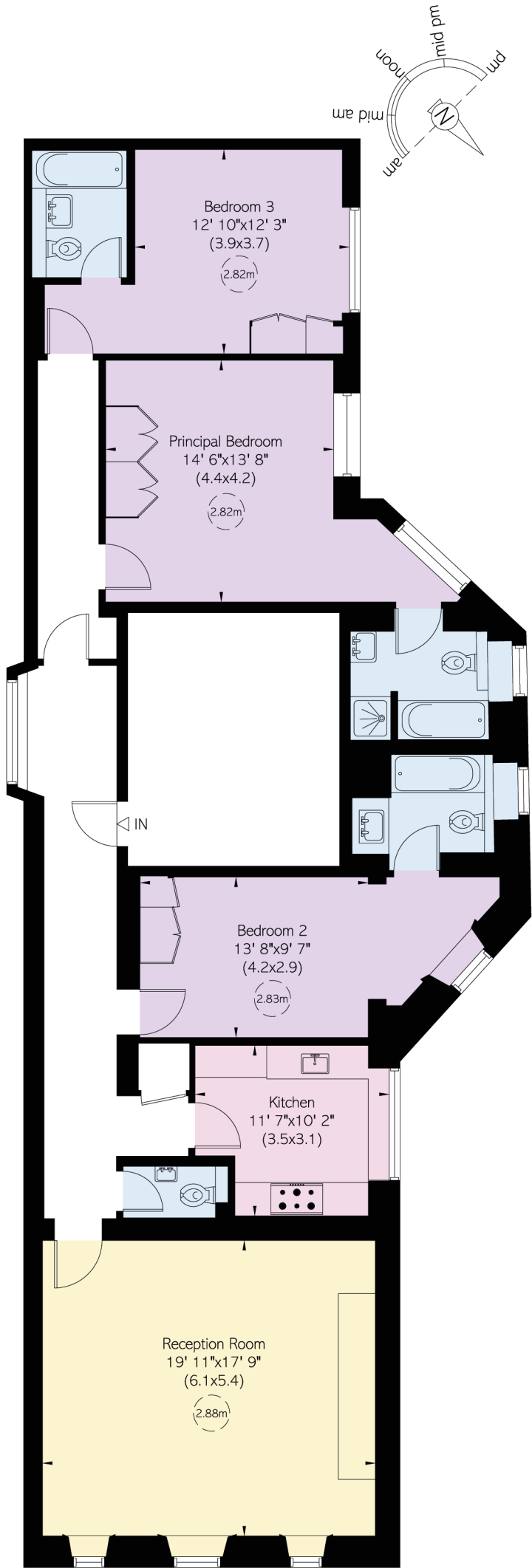

First Floor